

Round Bars

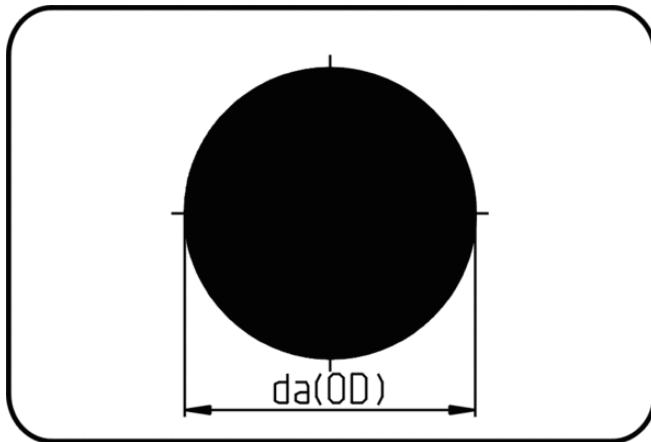

Code: 800

- **Round Bar**
- according to DIN 15860 - L=1m
- extruded
- **ECTFE natural**

Dimension	Code	Detail	da(OD) mm	Weight
20	40.800.0020.10	20-1m	20	0.56
25	40.800.0025.10	25-1m	25	0.87
30	40.800.0030.10	30-1m	30	1.25
40	40.800.0040.10	40-1m	40	2.21
50	40.800.0050.10	50-1m	50	3.46
65	40.800.0065.10	65-1m	65	5.82
80	40.800.0080.10	80-1m	80	8.83
100	40.800.0100.10	100-1m	100	13.82