

Round Bars

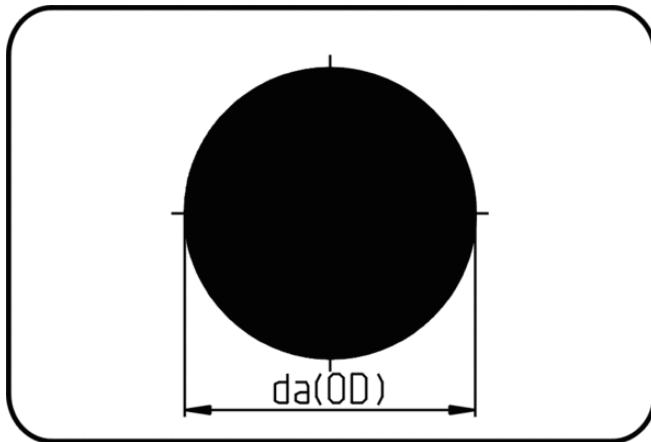

Code: 800

- Round Bar
- according to DIN 15860 - L=1m
- extruded
- PPR grey

Dimension	Code	Detail	da(OD) mm	Weight
15	11.800.0015.10	15-1m	15	0.17
20	11.800.0020.10	20-1m	20	0.30
25	11.800.0025.10	25-1m	25	0.47
30	11.800.0030.10	30-1m	30	0.67
35	11.800.0035.10	35-1m	35	0.91
40	11.800.0040.10	40-1m	40	1.19
45	11.800.0045.10	45-1m	45	1.51
50	11.800.0050.10	50-1m	50	1.87
55	11.800.0055.10	55-1m	55	2.25
60	11.800.0060.10	60-1m	60	2.69
70	11.800.0070.10	70-1m	70	3.64
75	11.800.0075.10	75-1m	75	4.17
80	11.800.0080.10	80-1m	80	4.77
90	11.800.0090.10	90-1m	90	6.04
100	11.800.0100.10	100-1m	100	7.47
110	11.800.0110.10	110-1m	110	9.04
125	11.800.0125.10	125-1m	125	11.70
140	11.800.0140.10	140-1m	140	14.60
160	11.800.0160.10	160-1m	160	19.20
180	11.800.0180.10	180-1m	180	24.30
200	11.800.0200.10	200-1m	200	30.00
220	11.800.0220.10	220-1m	220	36.20
250	11.800.0250.10	250-1m	250	46.50
300	11.800.0300.10	300-1m	300	66.80
325	11.800.0325.10	325-1m	325	78.62
360	11.800.0360.10	360-1m	360	96.30
410	11.800.0410.10	410-1m	410	125.00
510	11.800.0510.10	510-1m	510	193.00



Dimension	Code	Detail	da(OD) mm	Weight
640	11.800.0640.10	640-1m	640	303.00