

Round Bars

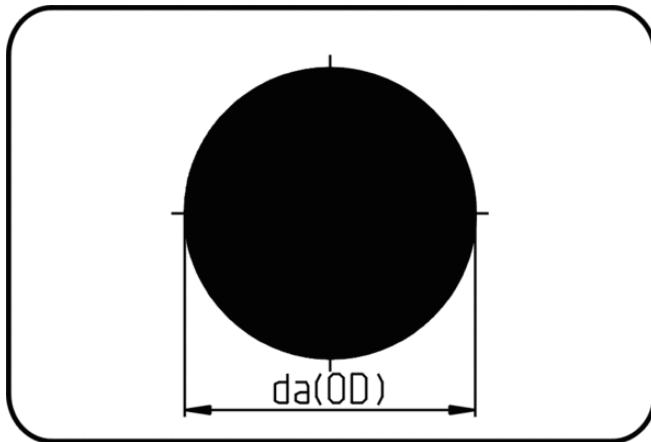

Code: 800

- **Round Bar**
- according to DIN 15860 - L=1m
- extruded
- **PVDF natural**

Dimension	Code	Detail	da(OD) mm	Weight
10	30.800.0010.10	10-1m	10	0.15
15	30.800.0015.10	15-1m	15	0.34
20	30.800.0020.10	20-1m	20	0.59
25	30.800.0025.10	25-1m	25	0.91
30	30.800.0030.10	30-1m	30	1.30
35	30.800.0035.10	35-1m	35	1.81
40	30.800.0040.10	40-1m	40	2.31
45	30.800.0045.10	45-1m	45	2.93
50	30.800.0050.10	50-1m	50	3.61
60	30.800.0060.10	60-1m	60	5.17
65	30.800.0065.10	65-1m	65	6.15
70	30.800.0070.10	70-1m	70	7.15
75	30.800.0075.10	75-1m	75	8.21
80	30.800.0080.10	80-1m	80	9.22
90	30.800.0090.10	90-1m	90	11.67
100	30.800.0100.10	100-1m	100	14.42
110	30.800.0110.10	110-1m	110	17.45
125	30.800.0125.10	125-1m	125	22.35
140	30.800.0140.10	140-1m	140	27.40
160	30.800.0160.10	160-1m	160	36.00
180	30.800.0180.10	180-1m	180	46.00
200	30.800.0200.10	200-1m	200	57.65
250	30.800.0250.10	250-1m	250	90.08
300	30.800.0300.10	300-1m	300	129.40
325	30.800.0325.10	325-1m	325	152.00
340	30.800.0340.10	340-1m	340	166.40