

## Round Bars

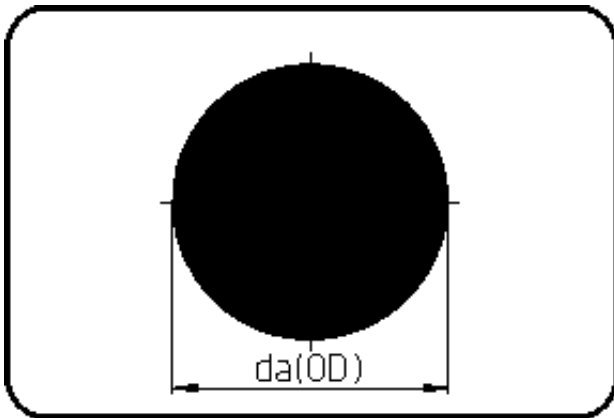

Code: 800

- Round Bar
- according to DIN 15860 - L=1m
- flame retardant & el-conduct.
- extruded
- **PPs-el black**

Dimension	Code	Detail	Weight
100	19.800.0100.10	100-1m	9.27

	Unit	Nominale	Tol+	Tol-
da(OD)	mm	100	3.80	-0.60