

Fittings

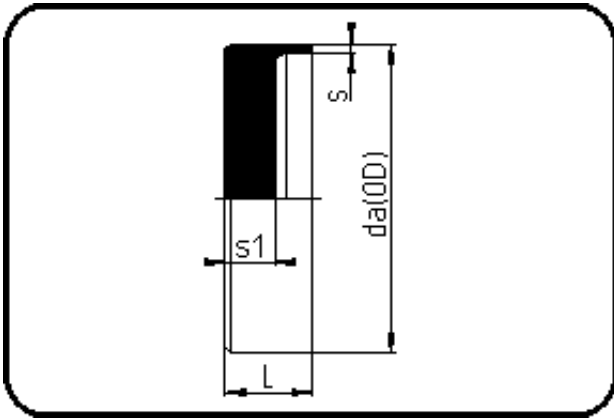

Code: 302

- End Cap
- machined
- **Butt-welding**
- **AGRU-Vent PVDF**

Dimension	Code	Detail	Weight
315	34.302.0315.00	315X4,0	2.92

	Unit	Nominale	Tol+	Tol-
da(OD)	mm	315	0.00	0.00
L	mm	35	1.50	1.50
s	mm	4	0.00	0.00
s1	mm	20	0.00	0.00