

## Fittings

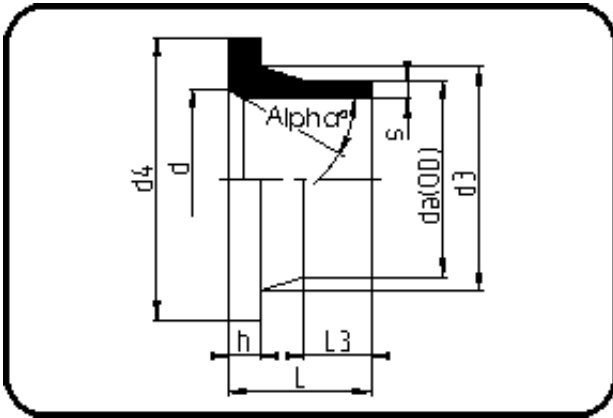

Code: 012.9

- **Chamfered Stub Flange DIN**
- for butterfly valves
- injection moulded+chamfered
- **Butt + IR-welding**
- **PVDF UHP natural**

Backing Rings please see Accessories.

Dimension	Code	Detail	Weight
180	35.012.9180.21	180X8,6 SDR21 ISO S-10	1.10

	Unit	Nominale	Tol+	Tol-
da(OD)	mm	180	1.10	0.00
L	mm	80	3.75	3.00
L3	mm	57	1.50	0.00
s	mm	8,6	1.10	0.00
d	mm	150	3.00	0.00
alph	[°]	30	0.00	3.00
d3	mm	183	0.00	4.50
h	mm	18	0.75	2.25
d4	mm	212	0.00	1.50