

Fittings

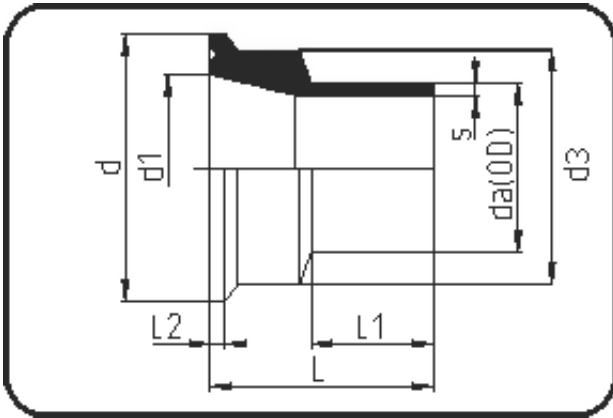

Code: 35.306

- Sanitary Joint Fitting
- machined
- **Butt + IR-welding**
- **PVDF UHP natural**

OD 25+63 ISO 1127, OD 20,32,40,50 ISO 2852. As sealing material we only recommend EPDM, FPM or EPDM/PTFE.

Dimension	Code	Detail	Weight
20	35.306.0020.21	20X1,9 SDR21 MOP 10 bar	0.04

	Unit	Nominale	Tol+	Tol-
da(OD)	mm	20	0.00	0.00
L	mm	42	0.75	0.75
L1	mm	23	0.75	0.75
L2	mm	2,8	0.15	0.00
s	mm	1,9	0.00	0.00
d	mm	50,5	0.15	0.15
d1	mm	18,1	0.00	0.08
d3	mm	40	0.00	0.30
da	inch	0,5	0.00	0.00