

Fittings

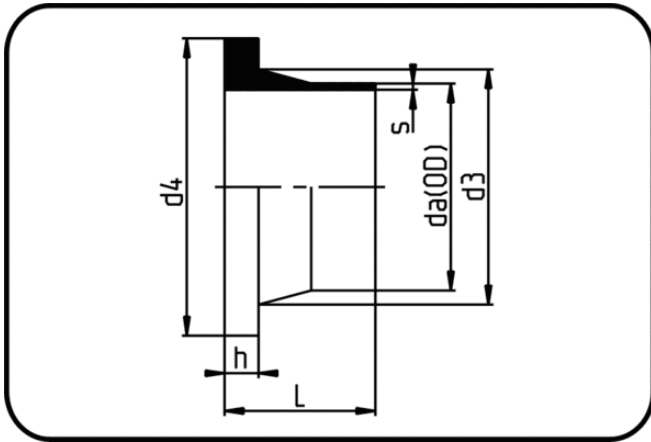

Code: 012.2

- **Stub Flange JIS**
- short spigot
- injection moulded
- **Butt + IR-welding**
- **PP Pure grey**

Backing Rings please see Accessories.

Dimension	Code	Detail	da(OD) mm	s mm	L mm	d3 mm	d4 mm	h mm	Weight
20	72.012.2020.11	20X1,9 SDR11 ISO S-5	20	1,9	52	27	45	7	0.01
25	72.012.2025.11	25X2,3 SDR11 ISO S-5	25	2,3	52	33	58	9	0.03
32	72.012.2032.11	32X2,9 SDR11 ISO S-5	32	2,9	50	40	68	10	0.04
40	72.012.2040.11	40X3,7 SDR11 ISO S-5	40	3,7	52	50	78	11	0.06
50	72.012.2050.11	50X4,6 SDR11 ISO S-5	50	4,6	53	61	84	12	0.08
63	72.012.2063.11	63X5,8 SDR11 ISO S-5	63	5,8	50	75	99	14	0.12
75	72.012.2075.11	75X6,8 SDR11 ISO S-5	75	6,8	50,5	89	119	16	0.18
90	72.012.2090.11	90X8,2 SDR11 ISO S-5	90	8,2	82	105	129	17	0.29
110	72.012.2110.11	110X10,0 SDR11 ISO S-5	110	10	82	125	154	18	0.44
125	72.012.2125.11	125X11,4 SDR11 ISO S-5	125	11,4	82	132	154	25	0.51
140	72.012.2140.11	140X12,7 SDR11 ISO S-5	140	12,7	92	155	185	25	0.78
160	72.012.2160.11	160X14,6 SDR11 ISO S-5	160	14,6	92	175	212	25	0.98
200	72.012.2200.11	200X18,2 SDR11 ISO S-5	200	18,2	114	232	265	32	1.94
225	72.012.2225.11	225X20,5 SDR11 ISO S-5	225	20,5	113	235	265	32	1.86
250	72.012.2250.11	250X22,7 SDR11 ISO S-5	250	22,7	130	285	320	35	3.22
280	72.012.2280.11	280X25,4 SDR11 ISO S-5	280	25,4	128	288	320	35	3.13