

Valves

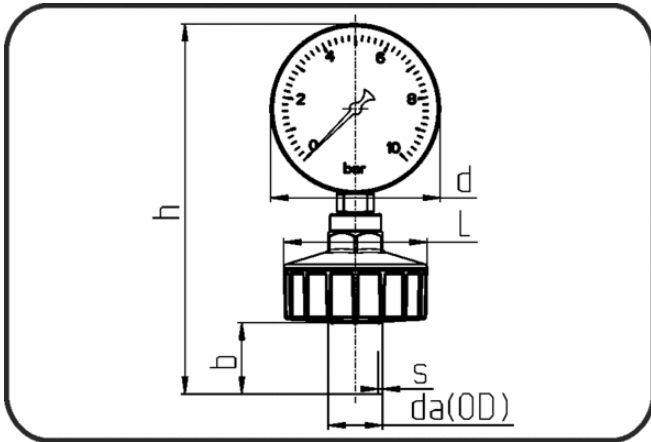

Code: 248.1

- Gauge guard Z800
- PTFE diaphragm
- Manometer 0-10 bar
- injection moulded
- **Butt + IR-welding**
- **PVDF UHP natural**

** On request.

Dimension	Code	Detail	da(OD) mm	s mm	L mm	d mm	h mm	b mm	Weight
25	35.248.1025.21	25 - SDR21 MOP 10 bar - 1/4	25	1,9	84,5	63	178	35	0.29
32	35.248.1032.21	32 - SDR21 MOP 10 bar - 1/2"	32	2,4	84,5	100	218	42	0.47