

Valves

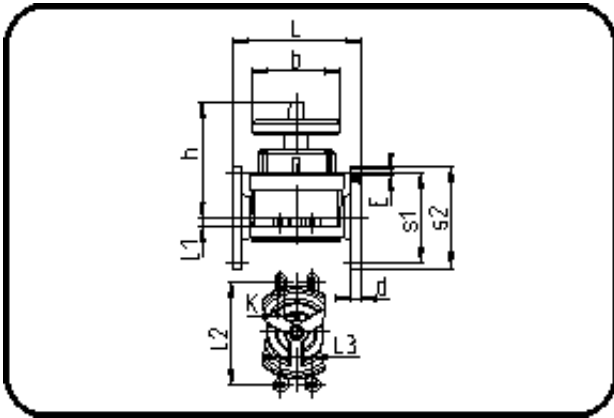

Code: 342.17

- Diaphragm Valve
- manually controlled
- EPDM/PTFE diaphragm
- Flange connection
- PP Pure grey

Dimension	Code	Detail	Weight
50	72.342.1750.11	50 - MOP 10 bar DIN/ANSI/JIS	1.94

	Unit	Nominale	Tol+	Tol-
L	mm	200	3.00	3.00
Kv-l	min	500	0.00	0.00
s2	mm	150	1.50	1.50
s1	mm	98,4	0.00	0.00
da(OD)	mm	50	0.50	0.00
L1	mm	32	0.75	0.75
L3	mm	0	0.00	0.00
L2	mm	44	0.75	0.75
b	mm	136	0.00	0.00
DN	mm	40	0.00	0.00
d	mm	23	0.00	0.00
E	mm	M16	0.00	0.00
h	mm	144	0.00	0.00
K	mm	M8	0.00	0.00
da	inch	1,5	0.00	0.00