

## Fittings

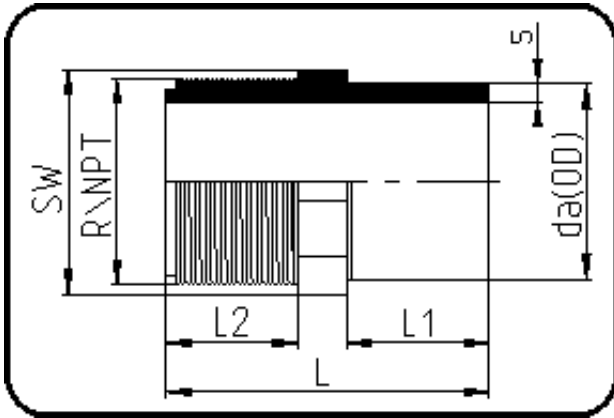

Code: 033

- Adaptor Male Thread
- R-thread
- injection moulded
- **Butt + IR + HPF-welding**
- **PVDF UHP natural**

Dimension	Code	Detail	Weight
32	35.033.3232.21	32X1" SDR21 MOP 10 bar	0.04

	Unit	Nominale	Tol+	Tol-
da(OD)	mm	32	0.30	0.00
L	mm	61	3.00	3.00
L1	mm	29	1.50	1.50
SW	mm	36	2.25	2.25
L2	mm	23	1.50	1.50
s	mm	2,4	0.50	0.00
R	inch	1	0.00	0.00
E	mm	33,25	0.00	0.00
K	mm	30,29	0.00	0.00