

## Fittings

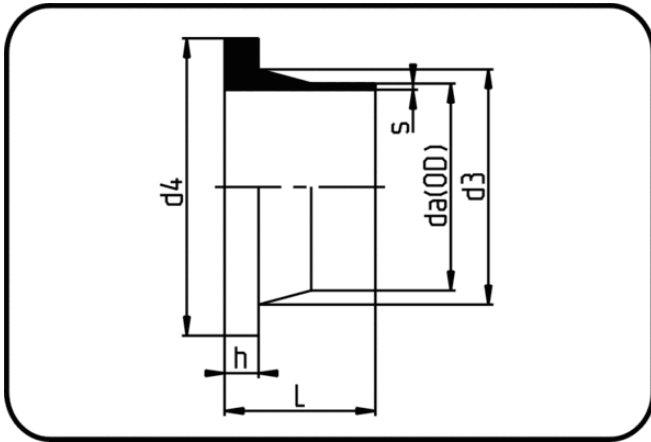

Code: 012.1

- **Stub Flange ANSI**
- short spigot
- injection moulded
- **Butt + IR-welding**
- **PVDF UHP natural**

Backing Rings please see Accessories.

Dimension	Code	Detail	da(OD) mm	s mm	L mm	d3 mm	d4 mm	h mm	Weight
90	35.012.1090.33	90X2,8 SDR33 ISO S-16	90	2,8	80	105	132,4	11	0.33
110	35.012.1110.33	110X3,4 SDR33 ISO S-16	110	3,4	80	125	158	12	0.46
125	35.012.1125.33	125X3,9 SDR33 ISO S-16	125	3,9	80	132	158	18	0.52
140	35.012.1140.33	140X4,3 SDR33 ISO S-16	140	4,3	80	155	188	15	0.67
160	35.012.1160.33	160X4,9 SDR33 ISO S-16	160	4,9	81	175	212	16	0.95
200	35.012.1200.33	200X6,2 SDR33 ISO S-16	200	6,2	100	232	268	18	1.90
225	35.012.1225.33	225X6,9 SDR33 ISO S-16	225	6,9	100	235	268	18	1.46
250	35.012.1250.33	250X7,7 SDR33 ISO S-16	250	7,7	100	285	320	20	2.79
315	35.012.1315.33	315X9,7 SDR33 ISO S-16	315	9,7	100	335	370	20	3.15
20	35.012.1020.21	20X1,9 SDR21 ISO S-10	20	1,9	49	27	44,5	6	0.03
25	35.012.1025.21	25X1,9 SDR21 ISO S-10	25	1,9	50	33	54,1	6,5	0.04
32	35.012.1032.21	32X2,4 SDR21 ISO S-10	32	2,4	50	40	63,5	7	0.06
40	35.012.1040.21	40X2,4 SDR21 ISO S-10	40	2,4	50	50	71,5	8	0.09
50	35.012.1050.21	50X3,0 SDR21 ISO S-10	50	3	50	61	82,6	9	0.12
63	35.012.1063.21	63X3,0 SDR21 ISO S-10	63	3	50	76	100,4	10	0.17
75	35.012.1075.21	75X3,6 SDR21 ISO S-10	75	3,6	50	89	117	10	0.20
90	35.012.1090.21	90X4,3 SDR21 ISO S-10	90	4,3	80	105	132,4	11	0.39
110	35.012.1110.21	110X5,3 SDR21 ISO S-10	110	5,3	80	125	158	12	0.56
125	35.012.1125.21	125X6,0 SDR21 ISO S-10	125	6	80	132	158	18	0.67
160	35.012.1160.21	160X7,7 SDR21 ISO S-10	160	7,7	81	175	212	16	1.09
200	35.012.1200.21	200X9,6 SDR21 ISO S-10	200	9,6	98	232	268	20	2.26
225	35.012.1225.21	225X10,8 SDR21 ISO S-10	225	10,8	100	235	268	20	1.92
250	35.012.1250.21	250X11,9 SDR21 ISO S-10	250	11,9	100	285	320	25	3.72