

Fittings

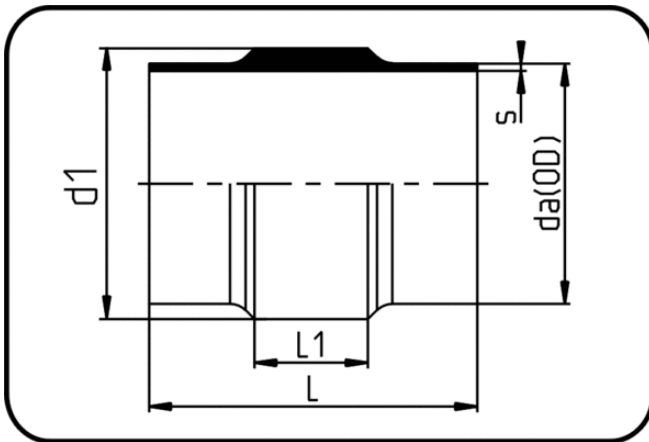

Code: 303.1

- Instrumentation Fitting
- without thread
- machined
- **Butt + IR-welding**
- **PVDF UHP natural**

Dimension	Code	Detail	da(OD) mm	s mm	L mm	d1 mm	L1 mm	Weight
200	35.303.1200.33	200X6,2 SDR33 ISO S-16	200	6,2	120	224	50	2.78
225	35.303.1225.33	225X6,9 SDR33 ISO S-16	225	6,9	130	246	50	1.96
250	35.303.1250.33	250X7,7 SDR33 ISO S-16	250	7,7	140	285	50	2.81
280	35.303.1280.33	280X8,6 SDR33 ISO S-16	280	8,6	140	298	50	2.80
20	35.303.1020.21	20X1,9 SDR21 ISO S-10	20	1,9	120	50	50	0.19
25	35.303.1025.21	25X1,9 SDR21 ISO S-10	25	1,9	120	55	50	0.26
32	35.303.1032.21	32X2,4 SDR21 ISO S-10	32	2,4	120	60	50	0.26
40	35.303.1040.21	40X2,4 SDR21 ISO S-10	40	2,4	120	75	50	0.36
50	35.303.1050.21	50X3,0 SDR21 ISO S-10	50	3	120	80	50	0.41
75	35.303.1075.21	75X3,6 SDR21 ISO S-10	75	3,6	140	105	50	0.63
200	35.303.1200.21	200X9,6 SDR21 ISO S-10	200	9,6	120	224	50	2.18
225	35.303.1225.21	225X10,8 SDR21 ISO S-10	225	10,8	130	246	50	2.58
250	35.303.1250.21	250X11,9 SDR21 ISO S-10	250	11,9	140	285	50	3.96
280	35.303.1280.21	280X13,4 SDR21 ISO S-10	280	13,4	140	298	50	3.82