

## Fittings

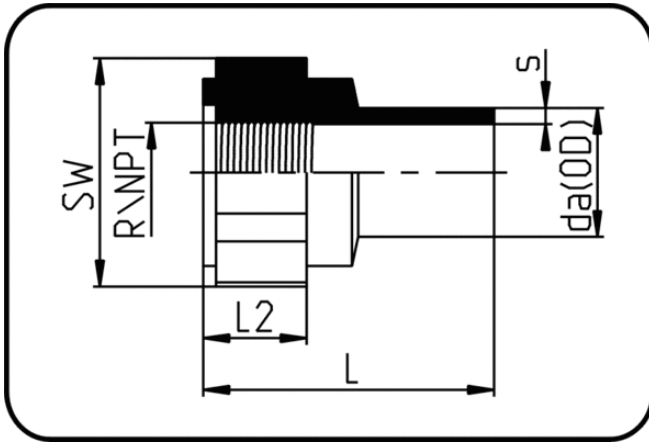

Code: 032.1

- Adaptor Female Thread
- NPT-thread/FRP-reinforced
- injection moulded
- **Butt + IR-welding**
- **PP Pure grey**

Dimension	Code	Detail	da(OD) mm	s mm	L mm	L2 mm	SW mm	NPT inch	Weight
20	72.032.2021.11	20X1/2" SDR11 ISO S-5	20	1,9	45	16	32	0,5	0.02
25	72.032.2526.11	25X3/4" SDR11 ISO S-5	25	2,3	51	18	41	0,75	0.02
32	72.032.3233.11	32X1" SDR11 ISO S-5	32	2,9	58	20	46	1	0.03
40	72.032.4041.11	40X1 1/4" SDR11 ISO S-5	40	3,7	62	24	55	1,25	0.05
50	72.032.5051.11	50X1 1/2" SDR11 ISO S-5	50	4,6	68	25,5	70	1,5	0.09
63	72.032.6364.11	63X2" SDR11 ISO S-5	63	5,8	75	30	85	2	0.16