

Fittings

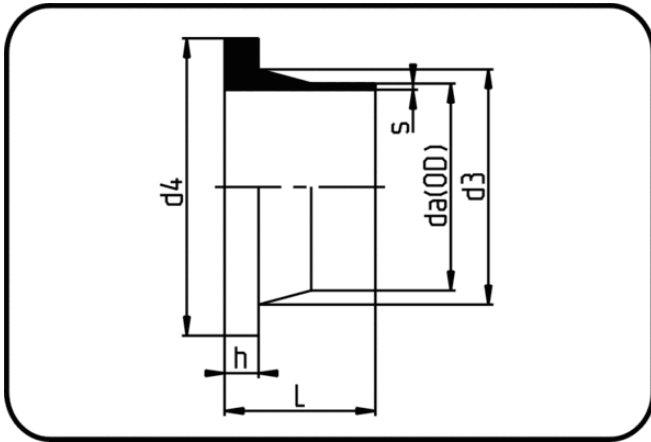

Code: 012

- **Stub Flange DIN**
- short spigot
- injection moulded
- **Butt + IR-welding**
- **PP natural**

Backing Rings please see Accessories.

Dimension	Code	Detail	da(OD) mm	s mm	L mm	d3 mm	d4 mm	h mm	Weight
20	16.012.0020.11	20X1,9 SDR11 ISO S-5	20	1,9	52	27	45	7	0.01
25	16.012.0025.11	25X2,3 SDR11 ISO S-5	25	2,3	52	33	58	9	0.03
32	16.012.0032.11	32X2,9 SDR11 ISO S-5	32	2,9	50	40	68	10	0.04
40	16.012.0040.11	40X3,7 SDR11 ISO S-5	40	3,7	52	50	78	11	0.06
50	16.012.0050.11	50X4,6 SDR11 ISO S-5	50	4,6	53	61	88	12	0.09
63	16.012.0063.11	63X5,8 SDR11 ISO S-5	63	5,8	50	75	102	14	0.13
90	16.012.0090.11	90X8,2 SDR11 ISO S-5	90	8,2	82	105	138	17	0.32
110	16.012.0110.11	110X10,0 SDR11 ISO S-5	110	10	82	125	158	18	0.45