

Fittings

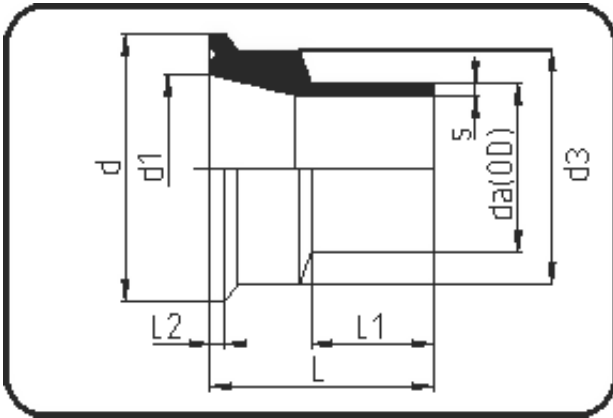

Code: 16.306

- Sanitary Joint Fitting
- machined
- **Butt + IR-welding**
- **PP natural**

OD 25+63 ISO 1127, OD 20,32,40,50 ISO 2852. As sealing material we only recommend EPDM, FPM or EPDM/PTFE.

Dimension	Code	Detail	Weight
32	16.306.0032.11	32X2,9 SDR11 ISO S-5	0.02

	Unit	Nominale	Tol+	Tol-
da(OD)	mm	32	0.30	0.00
L	mm	42	0.75	0.75
L1	mm	23	0.75	0.75
L2	mm	2,8	0.15	0.00
s	mm	2,9	0.40	0.00
d	mm	50,5	0.15	0.15
d1	mm	29,7	0.00	0.08
d3	mm	40	0.00	0.30
da	inch	1	0.00	0.00