

Fittings with short Spigot

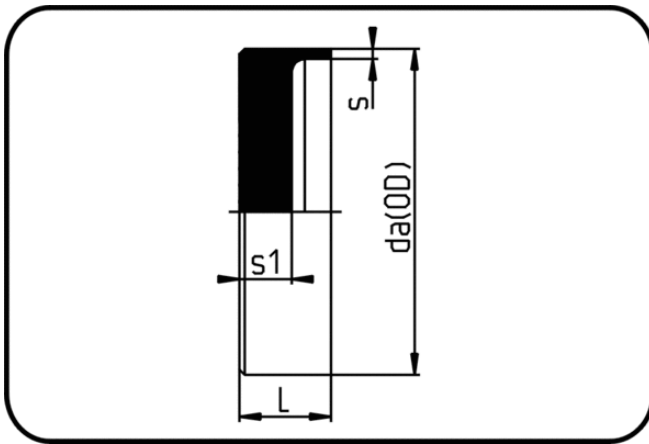

Code: 302

- End Cap
- short spigot
- machined
- **Butt-welding**
- **PE 100-RC black**

Dimension	Code	Detail	da(OD) mm	s mm	L mm	s1 mm	Weight
250	70.302.0250.09	250x27,9 SDR9 ISO S-4	250	27,9	80	55	2.90
280	70.302.0280.09	280x31,3 SDR9 ISO S-4	280	31,3	80	55	4.50
315	70.302.0315.09	315x35,2 SDR9 ISO S-4	315	35,2	85	60	5.10
355	70.302.0355.09	355x39,7 SDR9 ISO S-4	355	39,7	90	65	7.60
400	70.302.0400.09	400x44,7 SDR9 ISO S-4	400	44,7	95	70	7.80
450	70.302.0450.09	450x50,3 SDR9 ISO S-4	450	50,3	110	85	9.20
500	70.302.0500.09	500x55,8 SDR9 ISO S-4	500	55,8	120	95	10.40