

Fittings with short Spigot

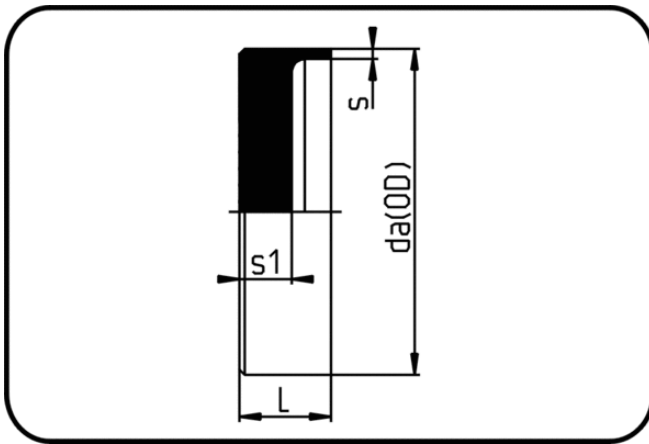

Code: 302

- End Cap
- short spigot
- machined
- **Butt-welding**
- **PE 100-RC black**

Dimension	Code	Detail	da(OD) mm	s mm	L mm	s1 mm	Weight
560	70.302.0560.11	560 X 50,8 SDR11 ISO S-5	560	50,8	120	93	23.00
630	70.302.0630.11	630 X 57,2 SDR11 ISO S-5	630	57,2	133	103	31.60
250	70.302.0250.07	250 SDR7,4 ISO S-3,2	250	34,2	80	55	3.31
280	70.302.0280.07	280 SDR7,4 ISO S-3,2	280	38,3	85	60	5.50
315	70.302.0315.07	315 SDR7,4 ISO S-3,2	315	43,1	90	65	6.00
355	70.302.0355.07	355 SDR7,4 ISO S-3,2	355	48,5	100	75	8.40
400	70.302.0400.07	400 SDR7,4 ISO S-3,2	400	54,7	105	80	11.60
450	70.302.0450.07	450 SDR7,4 ISO S-3,2	450	61,5	120	95	17.10
500	70.302.0500.07	500 SDR7,4 ISO S-3,2	500	68,3	130	105	23.20