

Segmented Fittings

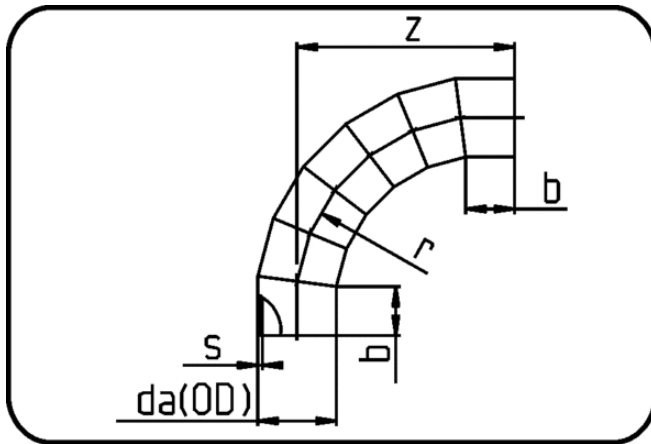

Code: 328

- Bend 90°
- 7 segments
- full pressure rated
- segmented
- **Butt + E-socket-welding**
- **PE 100-RC black**

Dimension	Code	Detail	da(OD) mm	s mm	r mm	b mm	t1 mm	z mm	Weight
140	70.328.0140.09	140x15,7 SDR9 ISO S-4	140	15,7	450	115	100	515	5.80
180	70.328.0180.09	180x20,1 SDR9 ISO S-4	180	20,1	470	175	100	595	10.60
225	70.328.0225.09	225x25,2 SDR9 ISO S-4	225	25,2	568	175	120	683	17.90
250	70.328.0250.09	250x27,9 SDR9 ISO S-4	250	27,9	581	175	120	696	19.70
280	70.328.0280.09	280x31,3 SDR9 ISO S-4	280	31,3	596	175	120	711	34.69
315	70.328.0315.09	315x35,2 SDR9 ISO S-4	315	35,2	613	175	120	728	38.00
355	70.328.0355.09	355x39,7 SDR9 ISO S-4	355	39,7	1.127	300	250	1.302	93.60
400	70.328.0400.09	400x44,7 SDR9 ISO S-4	400	44,7	1.149	300	250	1.324	120.50
450	70.328.0450.09	450x50,3 SDR9 ISO S-4	450	50,3	1.174	300	250	1.349	155.03
500	70.328.0500.09	500x55,8 SDR9 ISO S-4	500	55,8	1.199	300	250	1.374	194.14
560	70.328.0560.09	560x62,5 SDR9 ISO S-4	560	62,5	1.343	300	280	1.503	245.00
630	70.328.0630.09	630x70 SDR9 ISO S-4	630	70,3	1.378	350	280	1.588	338.00