

## Fittings with short Spigot

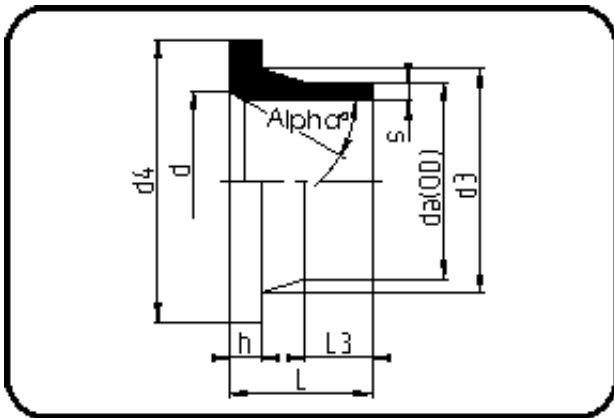

Code: 012.9

- Chamfered Stub Flange DIN
- for butterfly valves
- injection moulded+chamfered
- **Butt-welding**
- **PE 100-RC black**

Backing Rings please see Accessories.

Dimension	Code	Detail	Weight
90	70.012.9090.11	90X8,2 SDR11 ISO S-5	0.33

	Unit	Nominale	Tol+	Tol-
da(OD)	mm	90	0.90	0.00
L	mm	80	2.50	2.00
L3	mm	40	1.00	0.00
s	mm	8,2	1.00	0.00
d	mm	80	3.00	0.00
alph	[°]	30	0.00	3.00
d3	mm	105	0.00	3.00
h	mm	17	1.00	1.50
d4	mm	138	0.00	1.00