

Elongated Fittings

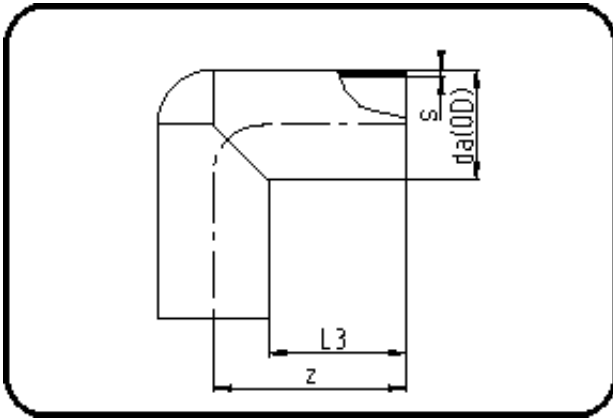

Code: 061

- Elbow 90°
- long spigot
- W/P-TW
- injection moulded+chamfered
- **Butt + E-socket-welding**
- PE 100-RC black

Dimension	Code	Detail	Weight
200	70.061.0200.09	200X22,4 SDR9 PN20	5.75

	Unit	Nominale	Tol+	Tol-
da(OD)	mm	200	1.20	0.00
L3	mm	114,5	2.00	2.00
s	mm	22,4	2.40	0.00
z	mm	214	2.00	2.00