

## Elongated Fittings

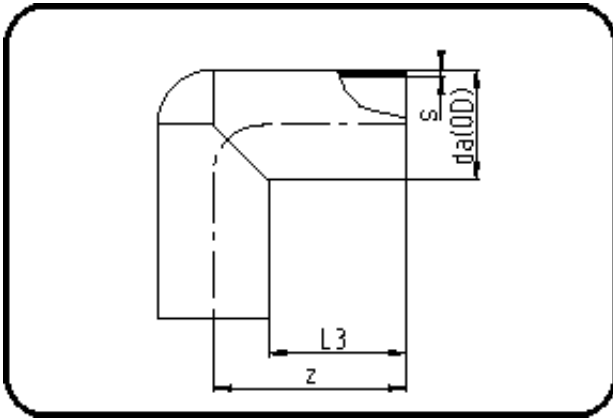

Code: 061

- Elbow 90°
- long spigot
- W/P-TW
- injection moulded+chamfered
- **Butt + E-socket-welding**
- PE 100-RC black

Dimension	Code	Detail	Weight
63	70.061.0063.09	63x7,1 SDR9 PN20	0.30

	Unit	Nominale	Tol+	Tol-
da(OD)	mm	63	0.40	0.00
L3	mm	76	1.00	1.00
s	mm	7,1	0.90	0.00
z	mm	109	1.00	1.00