

Elongated Fittings

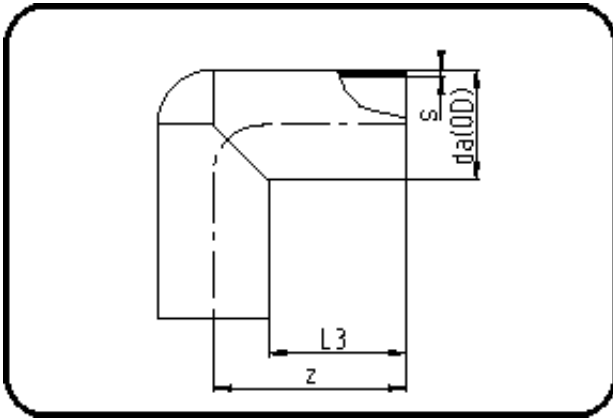

Code: 061

- Elbow 90°
- long spigot
- W/P-TW
- injection moulded+chamfered
- **Butt + E-socket-welding**
- PE 100-RC black

Dimension	Code	Detail	Weight
160	70.061.0160.09	160X17,9 SDR9 PN20	3.16

	Unit	Nominale	Tol+	Tol-
da(OD)	mm	160	1.00	0.00
L3	mm	101	1.50	1.50
s	mm	17,9	1.90	0.00
z	mm	180	1.50	1.50