

Electro Fusion Fittings

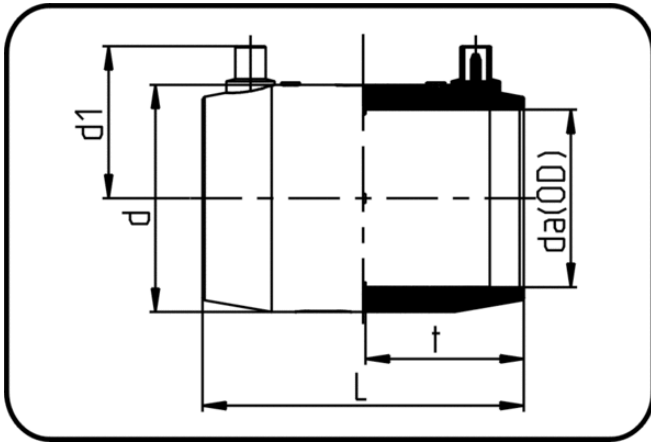

Code: 173

- **E-Coupler**
- MOP water 25bar/gas 10bar
- MOP water ÖVGW 16bar W/P-TW
- injection moulded
- **Electro-fusion**
- **PE 100-RC black**

Dimension	Code	Detail	da(OD) mm	L mm	d mm	d1 mm	t mm	Weight
20	70.173.0020.11	20 SDR 11-7,4	20	73,5	30	37	36	0.04
25	70.173.0025.11	25 SDR 11-7,4	25	79,5	35	39	39,5	0.04
32	70.173.0032.11	32 SDR 11-7,4	32	86,5	42	43	43	0.06
40	70.173.0040.11	40 SDR 17-7,4	40	97,5	53	47	48	0.10
50	70.173.0050.11	50 SDR 17-7,4	50	108,5	66,5	53	54	0.15
63	70.173.0063.11	63 SDR 17-7,4	63	124,5	83	59	62	0.25
75	70.173.0075.11	75 SDR 17-7,4	75	139,5	97	65,5	68,5	0.37
90	70.173.0090.11	90 SDR 17-7,4	90	138,5	112	72	68	0.44
110	70.173.0110.11	110 SDR 17-7,4	110	149	136	83	73	0.71
125	70.173.0125.11	125 SDR 17-7,4	125	169,5	155	91	83,5	0.99
140	70.173.0140.11	140 SDR 17-7,4	140	179	180	99	88,5	1.36
160	70.173.0160.11	160 SDR 17-7,4	160	180	197	109	88	1.70
180	70.173.0180.11	180 SDR 26-7,4	180	199,5	221	119	97,5	2.49
200	70.173.0200.11	200 SDR 26-7,4	200	215,5	245,5	128	105	2.84
225	70.173.0225.11	225 SDR 26-7,4	225	229	279	143	112	3.92
250	70.173.0250.11	250 SDR 26-7,4	250	238	310	155	116,5	5.14
280	70.173.0280.11	280 SDR 26-7,4	280	249	345	174	122	6.47
315	70.173.0315.11	315 SDR 26-7,4	315	259	386	187	127,5	8.44