

Fittings with short Spigot

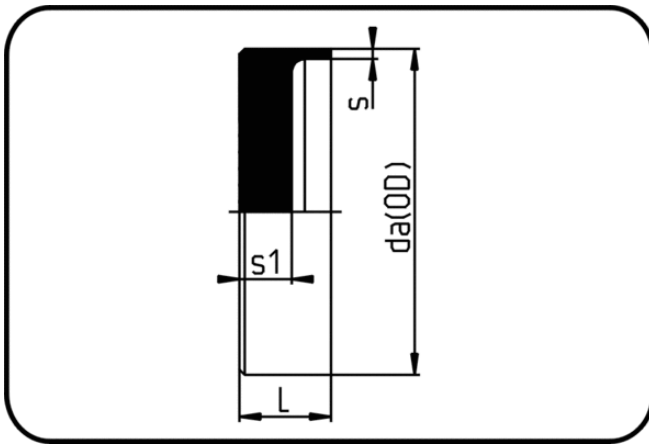

Code: 302

- End Cap
- short spigot
- machined
- **Butt-welding**
- **PE 100-RC black**

Dimension	Code	Detail	da(OD) mm	s mm	L mm	s1 mm	Weight
560	70.302.0560.11	560 X 50,8 SDR11 ISO S-5	560	50,8	120	93	23.00
630	70.302.0630.11	630 X 57,2 SDR11 ISO S-5	630	57,2	133	103	31.60