

Elongated Fittings

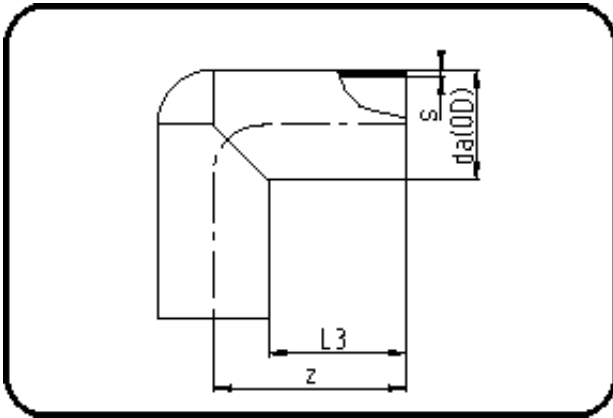

Code: 061

- **Elbow 90°**
- long spigot
- W/P-TW
- injection moulded+chamfered
- **Butt + E-socket-welding**
- **PE 100-RC black**

Dimension	Code	Detail	Weight
90	70.061.0090.09	90X10,1 SDR9 PN20	0.73

	Unit	Nominale	Tol+	Tol-
da(OD)	mm	90	0.60	0.00
L3	mm	82,5	1.00	1.00
s	mm	10,1	1.20	0.00
z	mm	126	1.00	1.00