

## Elongated Fittings

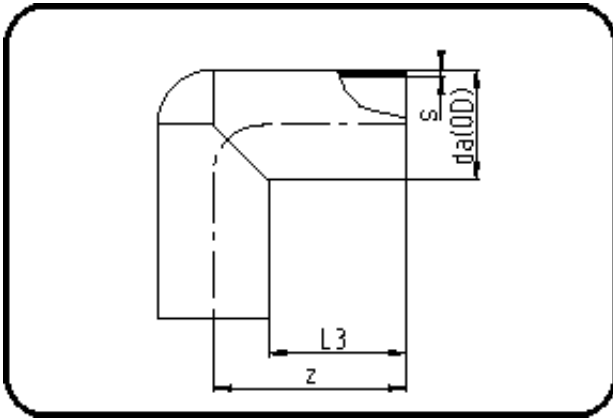

Code: 061

- **Elbow 90°**
- long spigot
- W/P-TW
- injection moulded
- **Butt + E-socket-welding**
- **PE 100-RC black**

Dimension	Code	Detail	Weight
250	70.061.0250.11	250X22,7 SDR11 PN16	9.44

	Unit	Nominale	Tol+	Tol-
da(OD)	mm	250	1.50	0.00
L3	mm	175	4.50	4.50
s	mm	22,7	2.40	0.00
z	mm	304	4.50	4.50