

Elongated Fittings

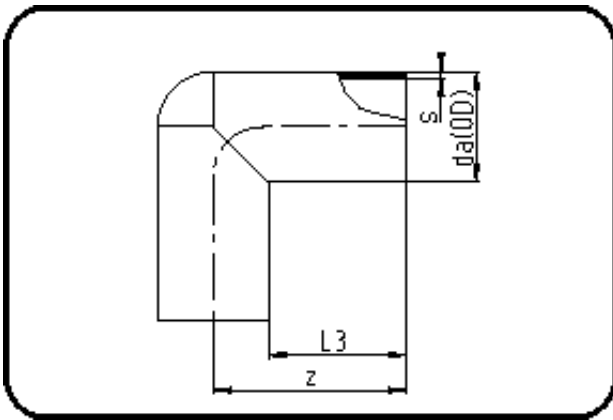

Code: 061

- **Elbow 90°**
- long spigot
- W/P-TW
- injection moulded
- **Butt + E-socket-welding**
- **PE 100-RC black**

Dimension	Code	Detail	Weight
75	70.061.0075.09	75X8,4 SDR9 PN20	0.49

	Unit	Nominale	Tol+	Tol-
da(OD)	mm	75	0.50	0.00
L3	mm	84,5	1.50	1.50
s	mm	8,4	1.00	0.00
z	mm	124,5	1.50	1.50