

## Electro Fusion Fittings

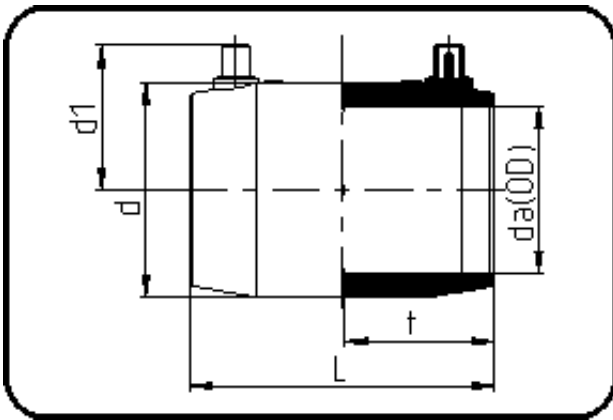

Code: 173

- **E-Coupler**
- MOP water 10bar/gas 6bar
- W/P-TW
- injection moulded
- **Electro-fusion**
- **PE 100-RC black**

Dimension	Code	Detail	Weight
160	70.173.0160.17	160 SDR 26-17	1.08

	Unit	Nominale	Tol+	Tol-
da(OD)	mm	160	0.00	0.00
L	mm	179,5	4.50	0.00
d	mm	188	1.50	1.50
d1	mm	107,5	1.50	1.50
t	mm	88	4.50	0.00