

Backing Rings, Accessories

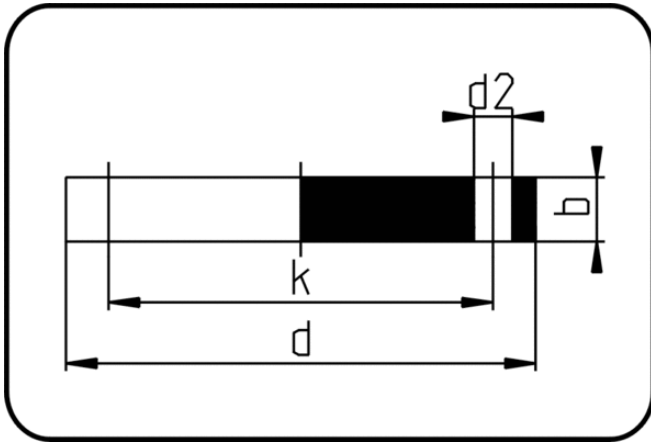

Code: 90.043

- Blind Flange ANSI
- ASME B16.5 Class 150
- Flange connection
- Steel hot dip galvanized

** On request.

Dimension	Code	Detail	da(OD) mm	d mm	d2 mm	b mm	k mm	Weight
355	90.043.0355.17	355 - 14" MOP 20 bar	355	535	29	33,4	476,25	57.00
400	90.043.0400.17	400 - 16" MOP 20 bar	400	595	29	35	539,75	68.00
450	90.043.0450.17	450 - 18" MOP 20 bar	450	635	32	38,1	577,85	102.00
500	90.043.0500.17	500 - 20" MOP 20 bar	500	700	32	41,3	635	120.00