

Fittings with short Spigot

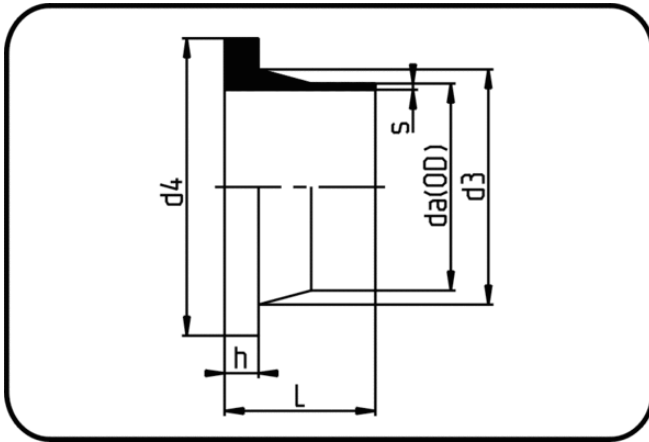

Code: 012.1

- **Stub Flange ANSI**
- short spigot
- injection moulded
- **Butt-welding**
- **PE 100-RC black**

Backing Rings please see Accessories.

Dimension	Code	Detail	da(OD) mm	s mm	L mm	d3 mm	d4 mm	h mm	Weight
20	70.012.1020.11	20X2,0 SDR11 ISO S-5	20	2	52	27	44,5	7	0.02
25	70.012.1025.11	25X2,3 SDR11 ISO S-5	25	2,3	50	33	54,1	9	0.03
32	70.012.1032.11	32X3,0 SDR11 ISO S-5	32	3	50	40	63,5	10	0.04
40	70.012.1040.11	40X3,7 SDR11 ISO S-5	40	3,7	50	50	71,5	11	0.06
50	70.012.1050.11	50X4,6 SDR11 ISO S-5	50	4,6	53	61	82,55	12	0.09
63	70.012.1063.11	63X5,8 SDR11 ISO S-5	63	5,8	50	75	100,4	14	0.13
75	70.012.1075.11	75X6,8 SDR11 ISO S-5	75	6,8	50,5	89	117	16	0.19
90	70.012.1090.11	90X8,2 SDR11 ISO S-5	90	8,2	80	105	132,4	17	0.32
110	70.012.1110.11	110X10,0 SDR11 ISO S-5	110	10	80	125	158	18	0.47
125	70.012.1125.11	125X11,4 SDR11 ISO S-5	125	11,4	80	132	158	25	0.52
160	70.012.1160.11	160X14,6 SDR11 ISO S-5	160	14,6	92	175	212	25	1.02
200	70.012.1200.11	200X18,2 SDR11 ISO S-5	200	18,2	114	232	268	32	2.18
225	70.012.1225.11	225X20,5 SDR11 ISO S-5	225	20,5	113	235	268	32	2.08
250	70.012.1250.11	250X22,7 SDR11 ISO S-5	250	22,7	130	285	320	35	3.56
315	70.012.1315.11	315X28,6 SDR11 ISO S-5	315	28,6	136	335	370	35	4.92
355	70.012.1355.11	355X32,2 SDR11 ISO S-5	355	32,2	150	373	436	40	7.00
400	70.012.1400.11	400X36,3 SDR11 ISO S-5	400	36,3	155	427	493	46	9.04
450	70.012.1450.11	450X40,9 SDR11 ISO S-5	450	40,9	166	514	593	60	14.20
500	70.012.1500.11	500X45,4 SDR11 ISO S-5	500	45,4	175	530	593	60	15.61
560	70.012.1560.11	560X50,8 SDR11 ISO S-5	560	50,8	180	615	655	60	20.80
630	70.012.1630.11	630X57,2 SDR11 ISO S-5	630	57,2	175	642	697	60	22.10
710	70.012.1710.11	710X64,5 SDR11 ISO S-5	710	64,5	170	737	800	65	29.40