

## Elongated Fittings

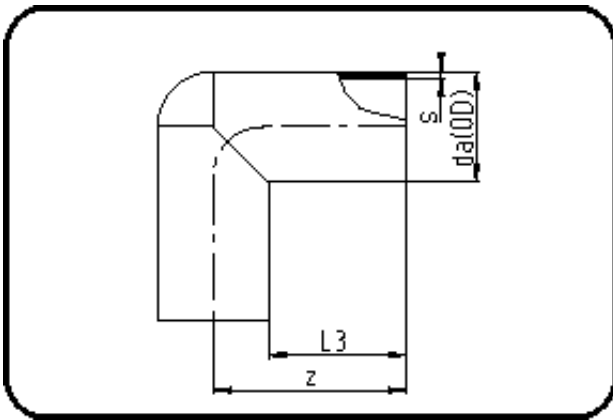

Code: 061

- **Elbow 90°**
- long spigot
- W/P-TW
- injection moulded
- **Butt + E-socket-welding**
- **PE 100-RC black**

Dimension	Code	Detail	Weight
315	70.061.0315.11	315X28,6 SDR11 PN16	18.10

	Unit	Nominale	Tol+	Tol-
da(OD)	mm	315	1.90	0.00
L3	mm	205	7.50	7.50
s	mm	28,6	3.00	0.00
z	mm	370	4.50	4.50