

Fittings with short Spigot

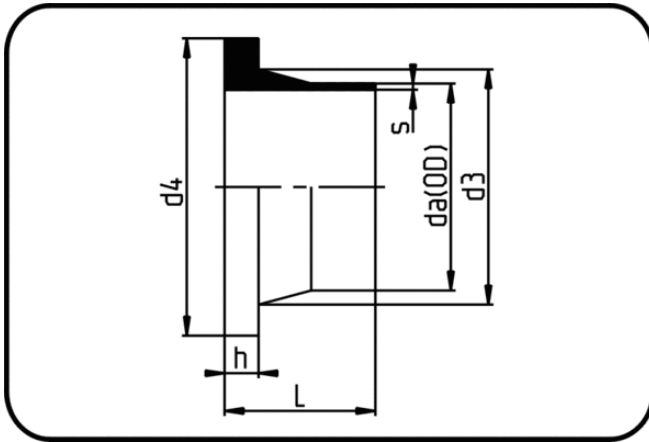

Code: 312

- Stub Flange DIN
- short spigot
- machined
- **Butt-welding**
- **PE 100-RC black**

Backing Rings please see Accessories.

Dimension	Code	Detail	da(OD) mm	s mm	L mm	d3 mm	d4 mm	h mm	Weight
800	70.312.0800.41	800X19,6 SDR41 MOP 2,0bar	800	19,6	120	840	905	50	12.00
900	70.312.0900.41	900X22,0 SDR41 MOP 2,0bar	900	22	130	944	1.005	55	16.00
1000	70.312.1000.41	1000X24,5 SDR41 MOP 2,0bar	1.000	24,5	140	1.047	1.110	60	21.00
1200	70.312.1200.41	1200X29,4 SDR41 MOP 2,0bar	1.200	29,4	160	1.245	1.330	70	34.00
1400	70.312.1400.41	1400X34,3 SDR41 MOP 2,0bar	1.400	34,3	180	1.425	1.535	80	51.00
1600	70.312.1600.41	1600X39,2 SDR41 MOP 2,0bar	1.600	39,2	195	1.655	1.760	95	78.00
1800	70.312.1800.41	1800X44,0 SDR41 MOP 2,0bar	1.800	44	210	1.860	1.960	110	108.00
2000	70.312.2000.41	2000x48,9 SDR41 MOP 2,0bar	2.000	48,9	230	2.070	2.170	130	153.00
2250	70.312.2250.41	2250x55,0 SDR41 MOP 2,0bar	2.250	55	250	2.320	2.435	150	216.00
2500	70.312.2500.41	2500X61,2 SDR41 MOP 2,0bar	2.500	61,2	275	2.550	2.705	165	338.00
800	70.312.0800.33	800X24,5 SDR33 MOP 2,5bar	800	24,5	120	840	905	50	15.60
900	70.312.0900.33	900X27,6 SDR33 MOP 2,5bar	900	27,6	120	944	1.005	55	17.00
1000	70.312.1000.33	1000X30,6 SDR33 MOP 2,5bar	1.000	30,6	140	1.047	1.110	60	22.00
1200	70.312.1200.33	1200X36,7 SDR33 MOP	1.200	36,7	160	1.245	1.330	70	36.00

Dimension	Code	Detail	da(OD) mm	s mm	L mm	d3 mm	d4 mm	h mm	Weight
		2,5bar							
1400	70.312.1400.33	1400X42,9 SDR33 MOP 2,5bar	1.400	42,9	180	1.425	1.535	80	53.00
1600	70.312.1600.33	1600X49 SDR33 MOP 2,5bar	1.600	49	195	1.655	1.760	95	82.00
1800	70.312.1800.33	1800X55,1 SDR33 MOP 2,5bar	1.800	55,1	210	1.860	1.960	110	113.00
2000	70.312.2000.33	2000X61,2 SDR33 MOP 2,5bar	2.000	61,2	230	2.070	2.170	130	161.00
2250	70.312.2250.33	2250X68,9 SDR33 MOP 2,5bar	2.250	68,9	250	2.320	2.435	150	226.00
2500	70.312.2500.33	2500X76,5 SDR33 MOP 2,5bar	2.500	76,5	275	2.550	2.705	165	348.00
800	70.312.0800.26	800X30,6 SDR26 MOP 3,2bar	800	30,6	125	840	905	55	15.00
900	70.312.0900.26	900X34,4 SDR26 MOP 3,2bar	900	34,4	135	944	1.005	60	23.80
1000	70.312.1000.26	1000X38,2 SDR26 MOP 3,2bar	1.000	38,2	145	1.047	1.110	65	25.00
1200	70.312.1200.26	1200X45,9 SDR26 MOP 3,2bar	1.200	45,9	165	1.245	1.330	75	40.00
1400	70.312.1400.26	1400X53,5 SDR26 MOP 3,2bar	1.400	53,5	185	1.425	1.535	85	60.00
1600	70.312.1600.26	1600X61,2 SDR26 MOP 3,2bar	1.600	61,2	200	1.655	1.760	100	90.00
1800	70.312.1800.26	1800X68,8 SDR26 MOP 3,2bar	1.800	68,8	225	1.860	1.960	125	133.00
2000	70.312.2000.26	2000X76,4 SDR26 MOP 3,2bar	2.000	76,4	240	2.070	2.170	140	180.00
2250	70.312.2250.26	2250X86,0 SDR26 MOP 3,2bar	2.250	86	255	2.320	2.435	155	245.00
2500	70.312.2500.26	2500X95,5 SDR26 MOP 3,2bar	2.500	95,5	285	2.550	2.705	175	367.00
800	70.312.0800.17	800X47,4 SDR17 MOP 5,0bar	800	47,4	140	840	905	65	26.00
900	70.312.0900.17	900X53,3 SDR17 MOP 5,0bar	900	53,3	150	944	1.005	70	25.00
1000	70.312.1000.17	1000X59,3 SDR17 MOP 5,0bar	1.000	59,3	190	1.047	1.110	75	33.00
1200	70.312.1200.17	1200X71,1 SDR17 MOP 5,0bar	1.200	71,1	185	1.245	1.330	90	54.00
1400	70.312.1400.17	1400X83,0 SDR17 MOP 5,0bar	1.400	83	200	1.425	1.535	100	76.00
1600	70.312.1600.17	1600X94,8 SDR17 MOP 5,0bar	1.600	94,8	210	1.655	1.760	110	109.00
1800	70.312.1800.17	1800X106,6 SDR17 MOP 5,0bar	1.800	106,6	225	1.860	1.960	125	152.00

Dimension	Code	Detail	da(OD) mm	s mm	L mm	d3 mm	d4 mm	h mm	Weight
2000	70.312.2000.17	2000X118,5 SDR17 MOP 5,0bar	2.000	118,5	240	2.070	2.170	140	204.00
2250	70.312.2250.17	2250X133,3 SDR17 MOP 5,0bar	2.250	133,3	260	2.320	2.435	160	284.00
2500	70.312.2500.17	2500X148,1 SDR17 MOP 5,0bar	2.500	148,1	285	2.550	2.705	175	406.00