

Segmented Fittings

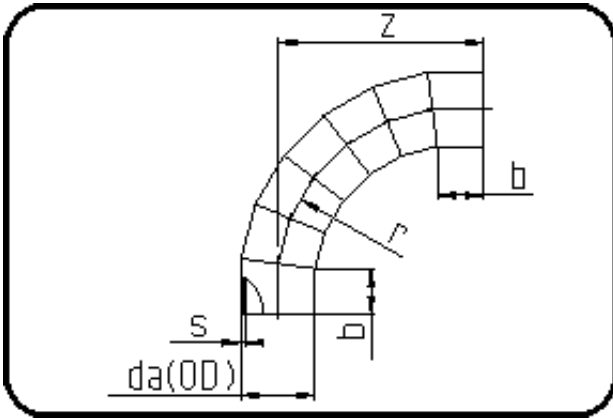

Code: 328

- Bend 90°
- 7 segments
- full pressure rated
- segmented
- **Butt + E-socket-welding**
- **PE 100-RC black**

Dimension	Code	Detail	Weight
280	70.328.0280.09	280x31,3 SDR9 ISO S-4	34.69

	Unit	Nominale	Tol+	Tol-
da(OD)	mm	280	0.00	0.00
b	mm	175	0.00	0.00
r	mm	596	0.00	0.00
s	mm	31,3	0.00	0.00
t	mm	194	0.00	0.00
t1	mm	120	0.00	0.00
t2	mm	212	0.00	0.00
z	mm	711	42.00	42.00