

Electro Fusion Fittings

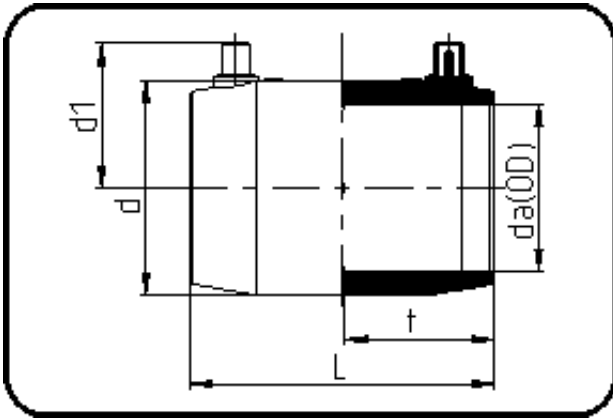

Code: 173

- **E-Coupler**
- MOP water 10bar/gas 6bar
- W/P-TW
- injection moulded
- **Electro-fusion**
- **PE 100-RC black**

Dimension	Code	Detail	Weight
180	70.173.0180.17	180 SDR 26-17	1.62

	Unit	Nominale	Tol+	Tol-
da(OD)	mm	180	0.00	0.00
L	mm	199	4.50	0.00
d	mm	212	1.00	1.00
d1	mm	117,5	1.00	1.00
t	mm	97	4.50	0.00