

## Elongated Fittings

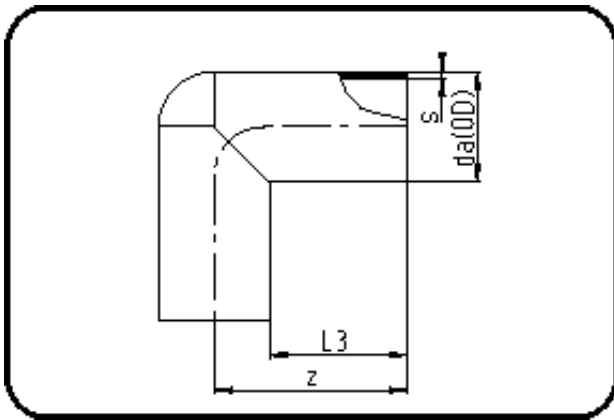

Code: 061

- **Elbow 90°**
- long spigot
- W/P-TW
- injection moulded+chamfered
- **Butt + E-socket-welding**
- **PE 100-RC black**

Dimension	Code	Detail	Weight
110	70.061.0110.09	110X12,3 SDR9 PN20	1.19

	Unit	Nominale	Tol+	Tol-
da(OD)	mm	110	0.70	0.00
L3	mm	88	1.00	1.00
s	mm	12,3	1.40	0.00
z	mm	145,5	1.00	1.00