

## Sweep Bends

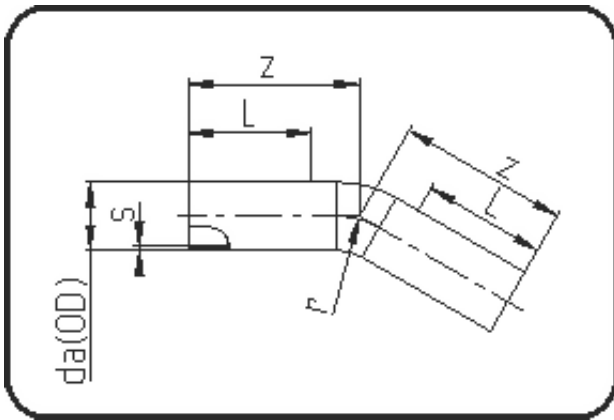

Code: 396

- Sweep Bend 30°
- radius 1.5 x OD
- formed out of pipe
- **Butt + E-socket-welding**
- **PE 100-RC black**

Dimension	Code	Detail	Weight
225	70.396.0225.11	225 SDR11 ISO S-5 16 bar	13.36

	Unit	Nominale	Tol+	Tol-
da(OD)	mm	225	0.00	0.00
L	mm	150	0.00	0.00
r	mm	338	0.00	0.00
s	mm	20,5	0.00	0.00
z	mm	520	75.00	75.00