

Sweep Bends

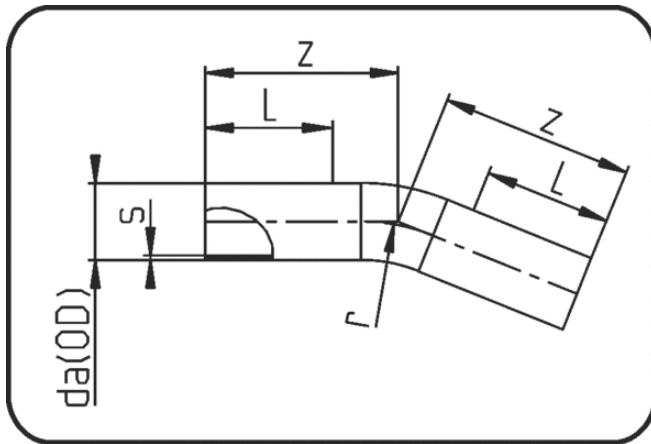

Code: 395

- Sweep Bend 22°
- radius 1.5 x OD
- formed out of pipe
- **Butt + E-socket-welding**
- **PE 100-RC black**

** On request.

| Dimension | Code | Detail | da(OD) mm | s mm | z mm | r mm | L mm | Weight |
|-----------|----------------|-------------------------|--------------|---------|---------|---------|---------|--------|
| 90 | 70.395.0090.09 | 90 SDR9 ISO S-4 20 bar | 90 | 10,1 | 210 | 135 | 150 | 1.70 |
| 110 | 70.395.0110.09 | 110 SDR9 ISO S-4 20 bar | 110 | 12,3 | 220 | 165 | 150 | 2.48 |
| 125 | 70.395.0125.09 | 125 SDR9 ISO S-4 20 bar | 125 | 14 | 240 | 188 | 150 | 3.67 |
| 140 | 70.395.0140.09 | 140 SDR9 ISO S-4 20 bar | 140 | 15,7 | 250 | 210 | 150 | 4.75 |
| 160 | 70.395.0160.09 | 160 SDR9 ISO S-4 20 bar | 160 | 17,9 | 260 | 480 | 150 | 6.79 |
| 180 | 70.395.0180.09 | 180 SDR9 ISO S-4 20 bar | 180 | 20,1 | 280 | 270 | 150 | 8.99 |
| 200 | 70.395.0200.09 | 200 SDR9 ISO S-4 20 bar | 200 | 22,4 | 290 | 300 | 150 | 12.20 |
| 225 | 70.395.0225.09 | 225 SDR9 ISO S-4 20 bar | 225 | 25,2 | 300 | 338 | 150 | 16.00 |
| 250 | 70.395.0250.09 | 250 SDR9 ISO S-4 20 bar | 250 | 27,9 | 450 | 375 | 250 | 21.19 |
| 280 | 70.395.0280.09 | 280 SDR9 ISO S-4 20 bar | 280 | 31,3 | 460 | 420 | 250 | 26.64 |
| 315 | 70.395.0315.09 | 315 SDR9 ISO S-4 20 bar | 315 | 35,2 | 500 | 496 | 300 | 39.00 |
| 355 | 70.395.0355.09 | 355 SDR9 ISO S-4 20 bar | 355 | 39,7 | 580 | 560 | 300 | 55.30 |
| 400 | 70.395.0400.09 | 400 SDR9 ISO S-4 20 bar | 400 | 44,7 | 600 | 637 | 300 | 66.20 |
| 450 | 70.395.0450.09 | 450 SDR9 ISO S-4 20 bar | 450 | 50,3 | 620 | 711 | 300 | 83.69 |
| 500 | 70.395.0500.09 | 500 SDR9 ISO S-4 20 bar | 500 | 55,8 | 650 | 783 | 350 | 117.00 |
| 560 | 70.395.0560.09 | 560 SDR9 ISO S-4 20 bar | 560 | 62,5 | 850 | 877 | 350 | 150.00 |
| 630 | 70.395.0630.09 | 630 SDR9 ISO S-4 20 bar | 630 | 62,5 | 850 | 955 | 350 | 200.00 |