

Sweep Bends

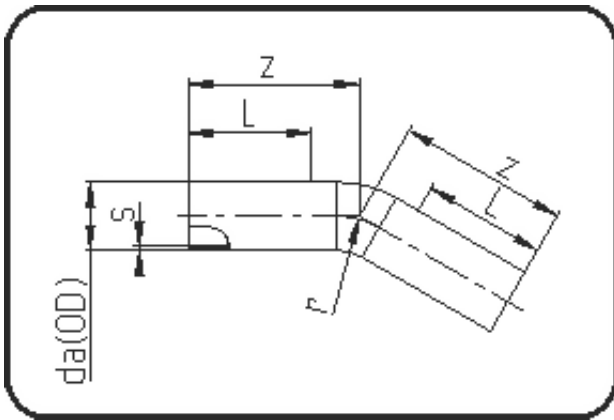

Code: 396

- Sweep Bend 30°
- radius 1.5 x OD
- formed out of pipe
- **Butt + E-socket-welding**
- **PE 100-RC black**

** On request.

Dimension	Code	Detail	Weight
110	70.396.0110.09	110 SDR9 ISO S-4 20 bar	2.48

	Unit	Nominale	Tol+	Tol-
da(OD)	mm	110	0.00	0.00
L	mm	150	0.00	0.00
r	mm	165	0.00	0.00
s	mm	12,3	0.00	0.00
z	mm	220	75.00	75.00