

Elongated Fittings

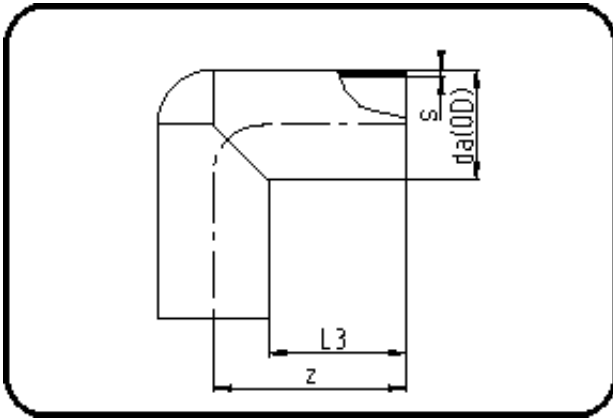

Code: 061

- Elbow 90°
- long spigot
- W/P-TW
- injection moulded
- **Butt + E-socket-welding**
- PE 100-RC black

Dimension	Code	Detail	Weight
125	70.061.0125.09	125X14,0 SDR9 PN20	1.74

	Unit	Nominale	Tol+	Tol-
da(OD)	mm	125	0.80	0.00
L3	mm	101	2.25	2.25
s	mm	14	1.50	0.00
z	mm	165	2.25	2.25