

## Fittings

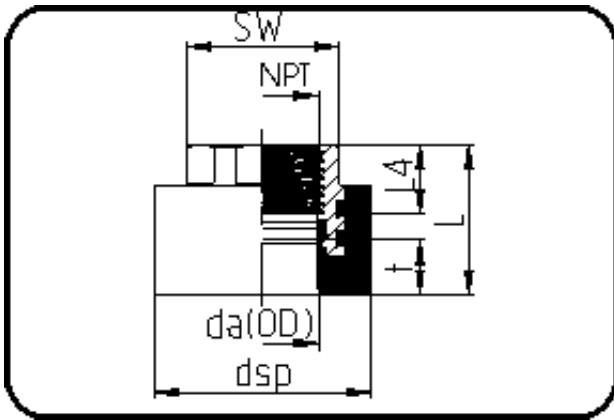

Code: 22.082.1

- Adaptor
- NPT metal female thread+hexag.
- injection moulded
- **Socket-welding**
- **PE 100 blue**

Dimension	Code	Detail	Weight
32	22.082.3233.07	32X1" - MOP 16 bar	0.21

	Unit	Nominale	Tol+	Tol-
da(OD)	mm	32	0.00	0.00
L	mm	46	0.75	0.75
NPT	inch	1	0.00	0.00
nr	ril	1,77	0.00	0.00
SW	mm	39	0.00	0.00
L4	mm	20	0.50	0.50
dsp	mm	53	0.75	0.75
t	mm	18,6	0.75	0.75
E	mm	10,16	0.00	0.00
p	bar	16	0.00	0.00
K	mm	30,83	0.00	0.00
da	inch	1	0.00	0.00