

## Electro Fusion Fittings

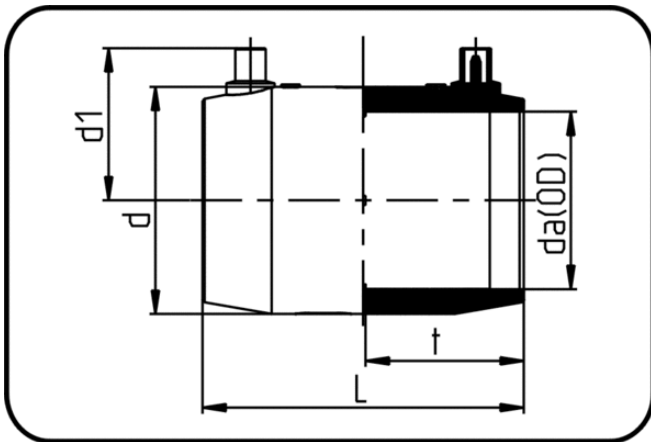

Code: 173

- **E-Coupler**
- MOP water 25bar/gas 10bar
- MOP water ÖVGW 16bar W/P-TW
- injection moulded
- **Electro-fusion**
- **PE 100-RC black**

| Dimension | Code           | Detail         | da(OD)<br>mm | L<br>mm | d<br>mm | d1<br>mm | t<br>mm | Weight |
|-----------|----------------|----------------|--------------|---------|---------|----------|---------|--------|
| 20        | 70.173.0020.11 | 20 SDR 11-7,4  | 20           | 73,5    | 30      | 37       | 36      | 0.04   |
| 25        | 70.173.0025.11 | 25 SDR 11-7,4  | 25           | 79,5    | 35      | 39       | 39,5    | 0.04   |
| 32        | 70.173.0032.11 | 32 SDR 11-7,4  | 32           | 86,5    | 42      | 43       | 43      | 0.06   |
| 40        | 70.173.0040.11 | 40 SDR 17-7,4  | 40           | 97,5    | 53      | 47       | 48      | 0.10   |
| 50        | 70.173.0050.11 | 50 SDR 17-7,4  | 50           | 108,5   | 66,5    | 53       | 54      | 0.15   |
| 63        | 70.173.0063.11 | 63 SDR 17-7,4  | 63           | 124,5   | 83      | 59       | 62      | 0.25   |
| 75        | 70.173.0075.11 | 75 SDR 17-7,4  | 75           | 139,5   | 97      | 65,5     | 68,5    | 0.37   |
| 90        | 70.173.0090.11 | 90 SDR 17-7,4  | 90           | 138,5   | 112     | 72       | 68      | 0.44   |
| 110       | 70.173.0110.11 | 110 SDR 17-7,4 | 110          | 149     | 136     | 83       | 73      | 0.71   |