

Fittings

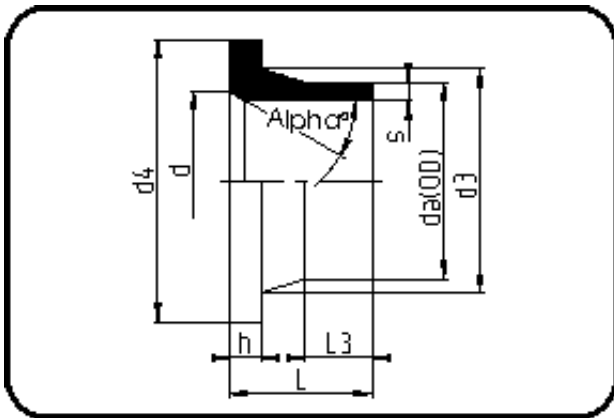

Code: 012.9

- **Chamfered Stub Flange DIN**
- for butterfly valves
- injection moulded+chamfered
- **Butt + IR-welding**
- **PVDF natural**

Backing Rings please see Accessories.

Dimension	Code	Detail	Weight
315	30.012.9315.21	315X15,0 SDR21 ISO S-10	3.30

	Unit	Nominale	Tol+	Tol-
da(OD)	mm	315	2.00	0.00
L	mm	102	3.00	2.00
L3	mm	41	1.00	0.00
s	mm	15	1.70	0.00
d	mm	308	3.00	0.00
alph	[°]	25	0.00	3.00
d3	mm	335	0.00	4.00
h	mm	25	0.50	1.50
d4	mm	370	0.00	1.00