

## Fittings

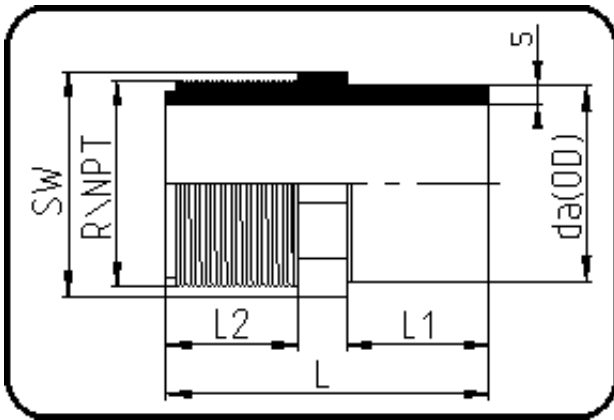

Code: 033.1

- Adaptor Male Thread
- NPT-thread
- injection moulded
- **Butt + IR + HPF-welding**
- PVDF natural

Dimension	Code	Detail	Weight
25	30.033.2526.21	25X3/4" SDR21 MOP 10 bar	0.02

	Unit	Nominale	Tol+	Tol-
da(OD)	mm	25	0.30	0.00
L	mm	51	3.00	3.00
L1	mm	23	1.50	1.50
NPT	inch	0,75	0.00	0.00
nr	ril	1,45	0.00	0.00
SW	mm	27	2.25	2.25
L2	mm	20	1.50	1.50
s	mm	1,9	0.40	0.00
E	mm	8,61	0.00	0.00
K	mm	24,58	0.00	0.00