

## Fittings for Socket Welding

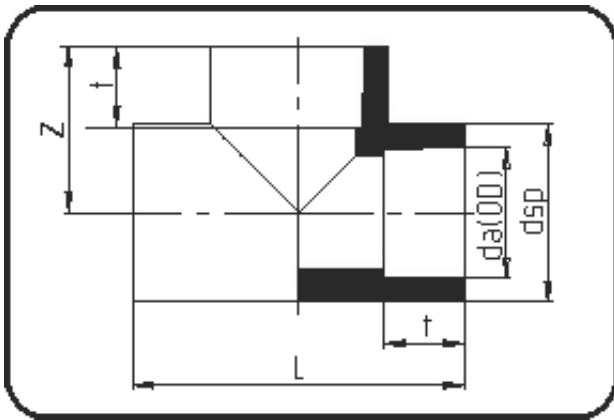

Code: 056

- Tee
- injection moulded
- **Socket-welding**
- PPR grey

Dimension	Code	Detail	Weight
63	11.056.0063.07	63 - MOP 20 bar	0.30

	Unit	Nominale	Tol+	Tol-
da(OD)	mm	63	0.00	0.00
L	mm	130	1.50	1.50
dsp	mm	81	0.75	0.75
t	mm	29	0.75	0.75
p	bar	20	0.00	0.00
z	mm	63,5	0.50	0.50