

## Valves

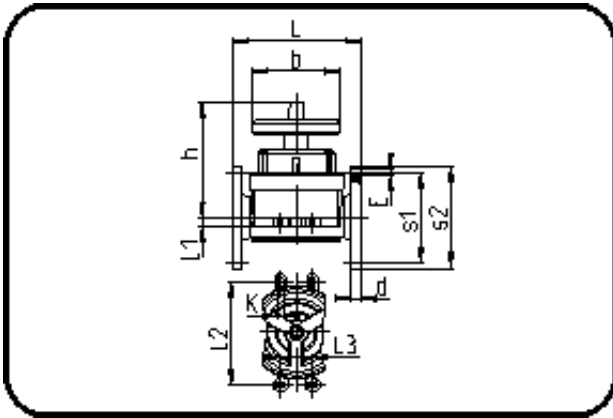

Code: 342.17

- Diaphragm Valve
- manually controlled
- EPDM/PTFE diaphragm
- Flange connection
- PP Pure grey

Dimension	Code	Detail	Weight
40	72.342.1740.11	40 - MOP 10 bar DIN/ANSI/JIS	1.79

	Unit	Nominale	Tol+	Tol-
L	mm	180	3.00	3.00
Kv-l	min	450	0.00	0.00
s2	mm	140	1.50	1.50
s1	mm	88,9	0.00	0.00
da(OD)	mm	40	0.40	0.00
L1	mm	25,5	0.75	0.75
L3	mm	0	0.00	0.00
L2	mm	44	0.75	0.75
b	mm	136	0.00	0.00
DN	mm	32	0.00	0.00
d	mm	19	0.00	0.00
E	mm	M16	0.00	0.00
h	mm	138	0.00	0.00
K	mm	M8	0.00	0.00
da	inch	1,25	0.00	0.00