

## Fittings for Socket Welding

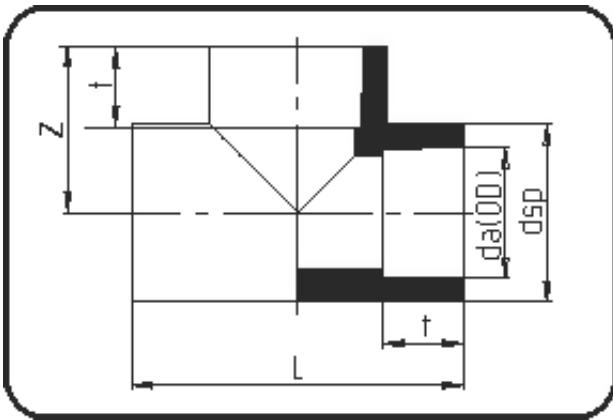

Code: 056

- Tee
- injection moulded
- **Socket-welding**
- **PPR grey**

Dimension	Code	Detail	Weight
90	11.056.0090.07	90 - MOP 16 bar	0.75

	Unit	Nominale	Tol+	Tol-
da(OD)	mm	90	0.00	0.00
L	mm	186	3.00	3.00
dsp	mm	114	0.75	0.75
t	mm	37,5	0.75	0.75
p	bar	16	0.00	0.00
z	mm	89	0.50	0.50