

Valves

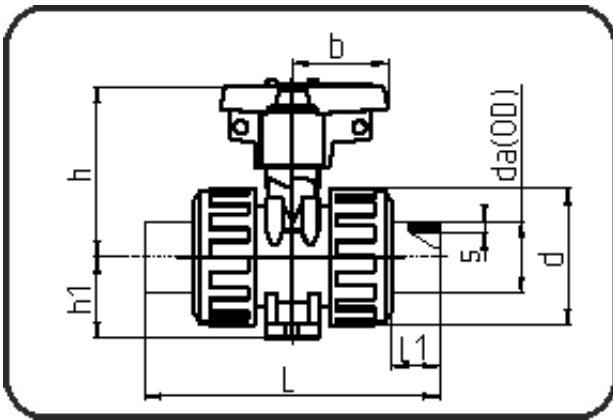

Code: 363.15

- Ball Valve M1
- FPM-sealing
- injection moulded
- **Butt + IR-welding**
- PP grey

Dimension	Code	Detail	Weight
32	11.363.1532.11	32 - SDR11 ISO S-5	0.31

	Unit	Nominale	Tol+	Tol-
da(OD)	mm	32	0.30	0.00
L	mm	156	1.50	1.50
L1	mm	18	0.75	0.75
h1	mm	43,5	0.75	0.75
b	mm	51	0.00	0.00
DN	mm	25	0.00	0.00
s	mm	2,9	0.40	0.00
d	mm	75,5	0.75	0.75
p	bar	10	0.00	0.00
h	mm	80	0.75	0.75