

## Fittings with short Spigot

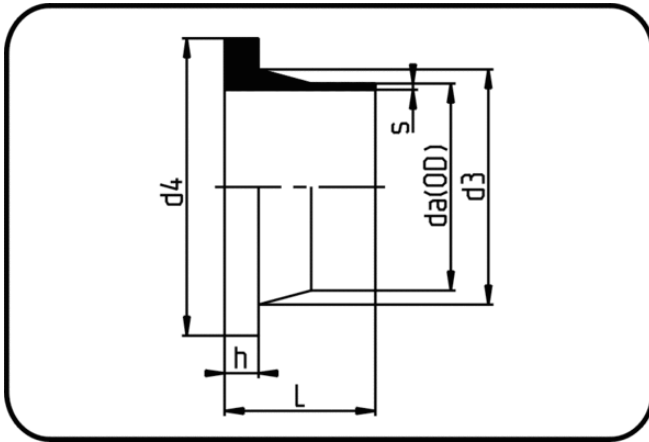

Code: 012.2

- Stub Flange JIS
- short spigot
- injection moulded
- **Butt-welding**
- **PPR grey**

Backing Rings please see Accessories.

Dimension	Code	Detail	da(OD) mm	s mm	L mm	d3 mm	d4 mm	h mm	Weight
20	11.012.2020.11	20X1,9 SDR11 ISO S-5	20	1,9	52	27	45	7	0.02
25	11.012.2025.11	25X2,3 SDR11 ISO S-5	25	2,3	52	33	58	9	0.03
32	11.012.2032.11	32X2,9 SDR11 ISO S-5	32	2,9	50	40	68	10	0.04
40	11.012.2040.11	40X3,7 SDR11 ISO S-5	40	3,7	52	50	78	11	0.06
50	11.012.2050.11	50X4,6 SDR11 ISO S-5	50	4,6	53	61	84	12	0.07
63	11.012.2063.11	63X5,8 SDR11 ISO S-5	63	5,8	50	75	99	14	0.12
75	11.012.2075.11	75X6,8 SDR11 ISO S-5	75	6,8	50,5	89	119	16	0.18
90	11.012.2090.11	90X8,2 SDR11 ISO S-5	90	8,2	82	105	129	17	0.29
110	11.012.2110.11	110X10,0 SDR11 ISO S-5	110	10	82	125	154	18	0.41
125	11.012.2125.11	125X11,4 SDR11 ISO S-5	125	11,4	82	132	154	25	0.51
140	11.012.2140.11	140X12,7 SDR11 ISO S-5	140	12,7	92	155	185	25	0.74
160	11.012.2160.11	160X14,6 SDR11 ISO S-5	160	14,6	92	175	212	25	0.94
200	11.012.2200.11	200X18,2 SDR11 ISO S-5	200	18,2	114	232	268	32	1.94
225	11.012.2225.11	225X20,5 SDR11 ISO S-5	225	20,5	113	235	265	32	1.90
250	11.012.2250.11	250X22,7 SDR11 ISO S-5	250	22,7	130	285	320	35	3.26
280	11.012.2280.11	280X25,4 SDR11 ISO S-5	280	25,4	128	288	320	35	3.02
315	11.012.2315.11	315X28,6 SDR11 ISO S-5	315	28,6	136	335	370	35	4.46