

Fittings

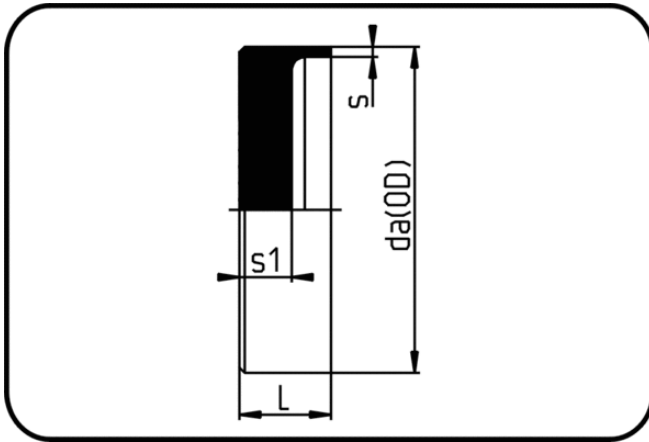

Code: 302

- End Cap
- short spigot
- machined
- **Butt + IR-welding**
- PVDF natural

Dimension	Code	Detail	da(OD) mm	s mm	L mm	s1 mm	Weight
125	30.302.0125.33	125X3,9 SDR33 ISO S-16	125	3,9	35	20	0.51
140	30.302.0140.33	140X4,3 SDR33 ISO S-16	140	4,3	35	20	0.62
160	30.302.0160.33	160X4,9 SDR33 ISO S-16	160	4,9	35	20	0.80
200	30.302.0200.33	200X6,2 SDR33 ISO S-16	200	6,2	35	20	1.27
225	30.302.0225.33	225X6,9 SDR33 ISO S-16	225	6,9	35	20	1.53
125	30.302.0125.21	125X6,0 SDR21 ISO S-10	125	6	35	20	0.54
140	30.302.0140.21	140X6,7 SDR21 ISO S-10	140	6,7	35	20	0.80
160	30.302.0160.21	160X7,7 SDR21 ISO S-10	160	7,7	35	20	0.80
200	30.302.0200.21	200X9,6 SDR21 ISO S-10	200	9,6	35	20	1.31
225	30.302.0225.21	225X10,8 SDR21 ISO S-10	225	10,8	35	20	1.46